

Recess Floor Profile Instruction – MGVC37

MERLYN

1. Floor channel must be recessed **8mm** into the floor.

2. Floor channels must be covered after installation. This prevents materials getting into the profile and obstructing glass fitting.

3. Floor channels **cannot** be used as wall channels due to the difference in depth dimension of the channels. If used this will could result in glass falling out of profile.

4. Ensure floor channels are plumb, true and level after installation. Failure to do so may cause installation issues.

5. Floor channels are fixed with tile adhesive.

6. Ensure the base of the floor channel is supported, by a bed of adhesive. As shown below:

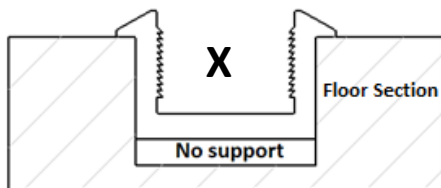

Incorrectly Installed

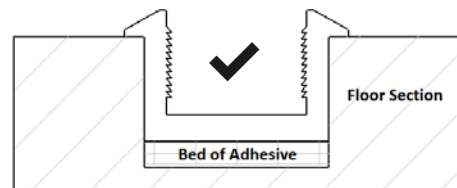

Correctly Installed

7. Floor profiles must be installed via a butt joint. The bottom face of the wall profile needs to be flush with the top face of the flush floor profile (i.e. wall profile sits on top of floor profile).

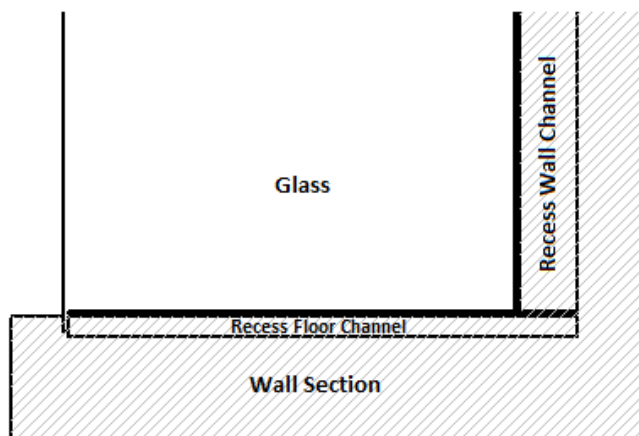

Recess Wall Profile Instruction – MGVC36

MERLYN

1. Ensure the lip of the profile sits flush against the surface of the wall.

2. Flush wall profiles **cannot** be installed on the corner of walls. i.e. Both sides of the channel need to be recessed.

3. Ensure wall channels are plumb, true and level after installation. Failure to do so, can cause installation issues.

4. Drill **5** equal distance, pilot holes in the wall profiles.

- These holes must then be countersunk as shown to accommodate **ø3mm stainless steel screws**.
- The screws must be a minimum of **35mm** in length.

5. Wall profiles must be installed via a butt joint. The bottom of the wall profile needs to be flush with the top face of the flush floor profile. (i.e. wall profile sits on top of floor profile).

6. When using **both** recess wall and floor channels, allow **5mm** tolerance at the top of the wall channels, for installation of the glass.

7. Use 10mm guide block provided to ensure the floor & wall channels are lined up correctly.

10mm Spacer Code – SP0MG9SPACER

